

Casement Windows

The Bereco casement window is no ordinary window. Incorporating quality materials and advanced manufacturing techniques it has unique benefits that enhance both its performance and security.

The casement outward opening window is the most common of all UK windows. Used across all market sectors the Bereco window has a number of improvements built in to the design as standard. Available in both flush and lipped (stormproof) styles for all configurations of window.

Design Features

- Internally glazed for better security
- Espagnolette locking
- Adjustment mechanism on the sash to assist fitting
- Secure night vent position available as an option
- Rounded edges for better paint coverage
- Drained and vented system
- 24mm double glazing- standard u value 1.37 W/m²K
- Grooved for internal window cill
- Stepped design to allow water to run off

Design Options

- Flush Casement
- Lipped Casement
- Regency Casement (top hung window with horns)

Flush and Lipped (storm proof) casement styles are available in any configuration of side hung or top hung window.

Regency casements have plant on horn detail to the upper sash to give the look of a traditional sliding sash.

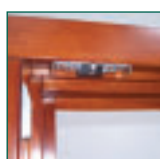

Optional night vent

Anti prise clips

Variable adjustment of sash in frame

Internally glazed – 24mm double glazing



Trickle ventilation through frame. This is concealed externally with specially designed head drip.



Espagnolette locking

Section Details

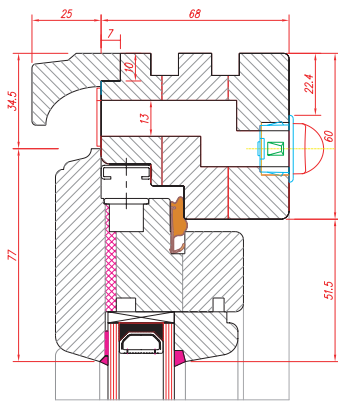

Lipped Head Section

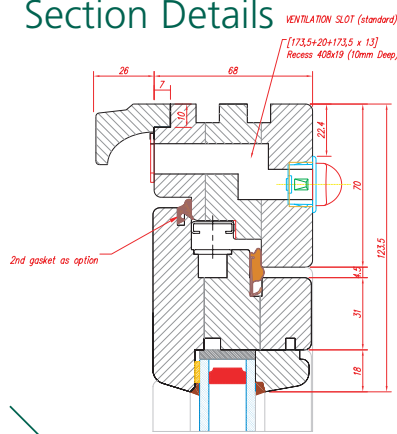

Flush Head Section

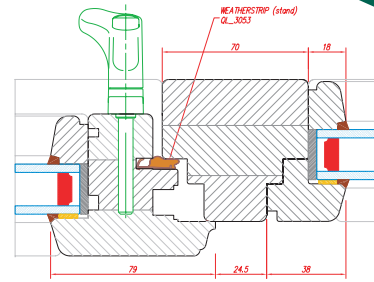

Mullion Section

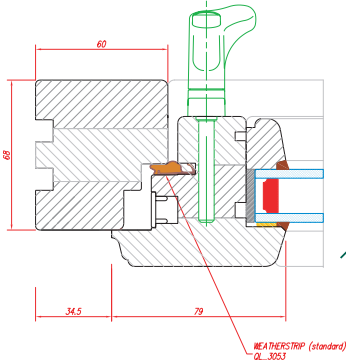

Jamb Section

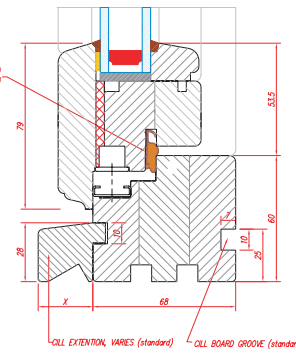
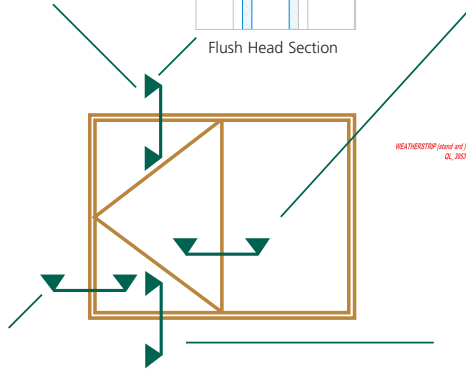

Lipped Sole Section

Bereco's unique stepped vent slot through the frame of the casement ensures maximum weather performance as well as lowering the internal trickle vent height away from the plaster line. In addition the flush vent eases installation.



Fire- Escape Regulations

Single Sash

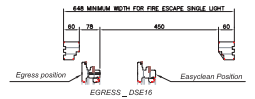

Note - Minimum window height 875mm to achieve 0.33m² with minimum window widths

Pair of sashes, Floating Mullion



Note - Minimum window height 875mm to achieve 0.33m² with minimum window widths

Sash/Fixed Light Offset Mullion

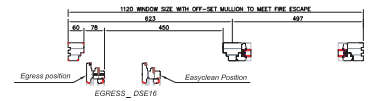

Note - Minimum window height 875mm to achieve 0.33m² with minimum window widths

Sash/Fixed light Central Mullion

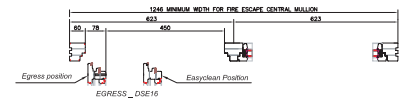

Note - Minimum window height 875mm to achieve 0.33m² with minimum window widths

The dimensions shown on the configurations above must be considered when specifying fire escape access.

Ironmongery Options

Depending on access requirements both Easy Clean and Egress hinges are available.



Easy Clean



Egress - for fire escape windows

